

IT IS HEREBY CERTIFIED THAT THE DIMENSIONS FOR PLANNING PURPOSES ARE AS SHOWN ON THE LAYOUT PLAN AND 1 TO 100 YEARS AS REQUIRED IN TERMS OF SECTION 144 OF THE NATIONAL WATER ACT OF 1957 APPEAR WITHIN THIS TOWNSHIP BOUNDARIES.

DATED 25 SEPTEMBER 2013

**NOTES:**

1. ALL FEETS AND DIMENSIONS ARE APPROXIMATE AND SUBJECT TO FINAL SURVEY.
2. A 300 SEPARATE VOTE DRAWING 2004/23/1901 OVER ERF 2623 AS SHOWN ON THE LAYOUT PLAN WILL BE CANCELLED.
3. THE STRAYS AT THE INTERSECTION OF MARYANNE AVE AND PARSELY AVE WILL BE 150m x 150m.
4. THE FIGURE A-B-C-D-E-A REPRESENTS THE TOWNSHIP BOUNDARY.
5. NO ACCESS ALONG THE LINE LETTERED A1-A2-A3-A4.
6. ERF 2623 WILL BE ZONED RESIDENTIAL 3 WITH A FSR OF 0.6, HEIGHT OF 14 METRE AND COVERAGE OF 60%.
7. ERF 2624 WILL BE ZONED SPECIAL FOR MOTOR DEALERS, SHOWS, SHOWROOMS AND OFFICES WITH A FSR OF 0.6, HEIGHT OF 2 STOREYS, COVERAGE OF 60% AND PARKING AS PER STRAIEC.
8. A 100m BOUNDING LINE IS APPLICABLE ALONG STRAID KAWAHTO DRIVE (CAMBERS) AND AFFECTS ERF 2624 AS SHOWN ON THE LAYOUT PLAN.

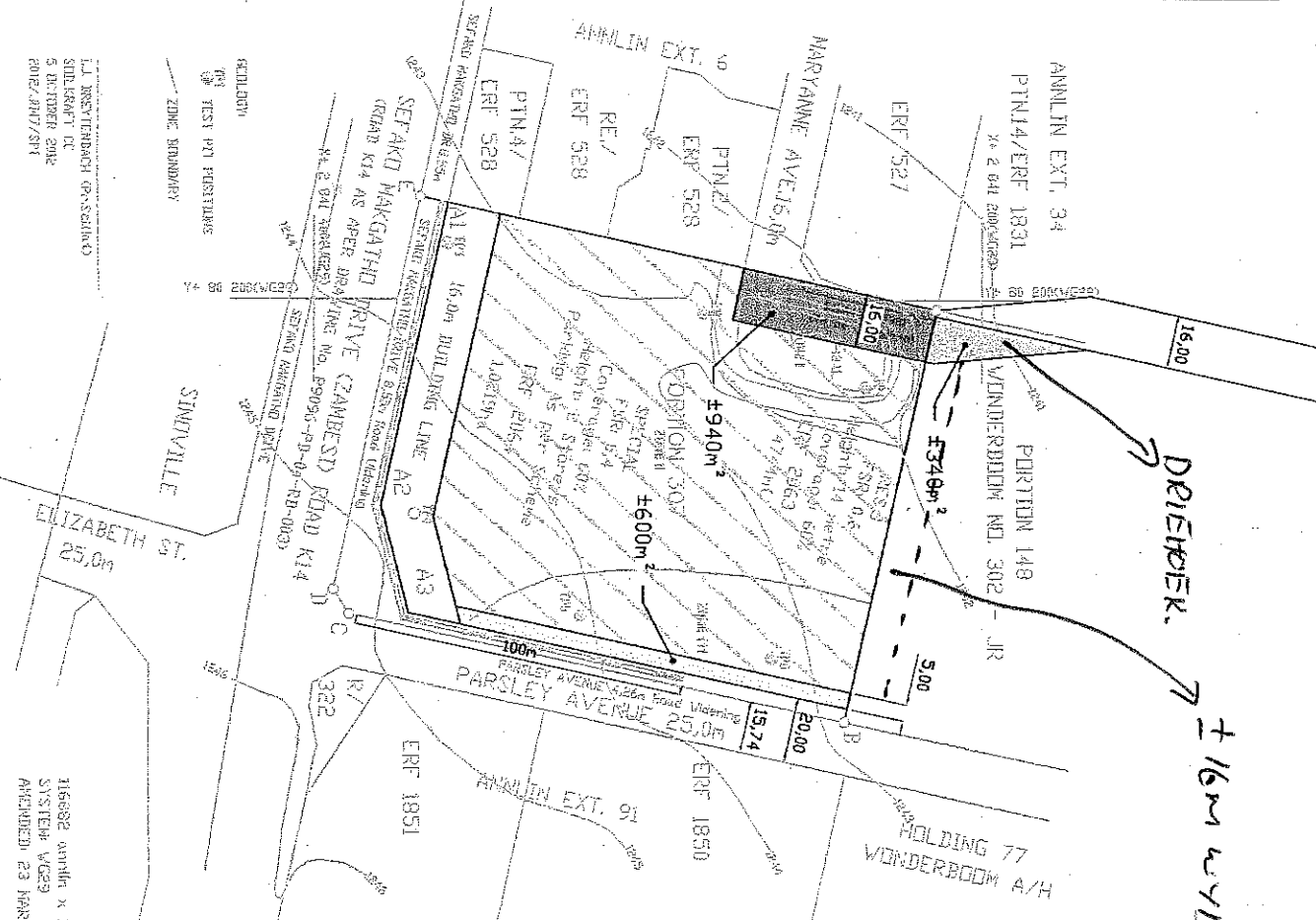

1.1. REVISIONS  
 1.2. DATE  
 1.3. BY  
 1.4. APPROVED BY

116682/1  
 SYSTEM WGS84  
 AMENDED: 23 MARCH 2013

**PROPOSED TOWNSHIP EXTENSION 181**

ANNLIN TOWNSHIP

EXTENSION 181

SUBMITTED ON PORTION 387 OF THE FARM WUNDERBOOM NO. 302 - JR

LOCAL AUTHORITY: CITY OF TSWANE, METROPOLITAN MUNICIPALITY

USE TABLE		USE TABLE	
NO OF ERVES	AREA (SQM)	% TOWNSHIP	ERF NUMBERS
1	0.4744	23.4321	2063
1	1.0219	50.4621	2064
<b>TOTAL</b>	<b>1.4963</b>	<b>73.8942</b>	

NO OF ERVES	AREA (SQM)	% TOWNSHIP	ERF NUMBERS
2	3.0250	15.11%	
<b>TOTAL</b>	<b>4.5213</b>	<b>22.7%</b>	

OWNER: DR. P. J. KOELLICH  
 ADDRESS: 116682/1  
 CONTACT: 011 461 1111

NO OF ERVES	AREA (SQM)	% TOWNSHIP	ERF NUMBERS
1	0.4744	23.4321	2063
1	1.0219	50.4621	2064
<b>TOTAL</b>	<b>1.4963</b>	<b>73.8942</b>	

OWNER: DR. P. J. KOELLICH  
 ADDRESS: 116682/1  
 CONTACT: 011 461 1111

**PLANKONSULT**

Stads en Streeklaanleg  
 Town and Regional Planning

Box 72729 Lynnwoodhof 0040  
 Tel: 012 391-5876  
 Fax: 012 391-7852  
 283 Lynnwood  
 Pretoria

SCALE: 1:1500

**PLANKONSULT**

Stads en Streeklaanleg  
 Town and Regional Planning

Box 72729 Lynnwoodhof 0040  
 Tel: 012 391-5876  
 Fax: 012 391-7852  
 283 Lynnwood  
 Pretoria